

## ENERGIZER NO. 123 (EL123)

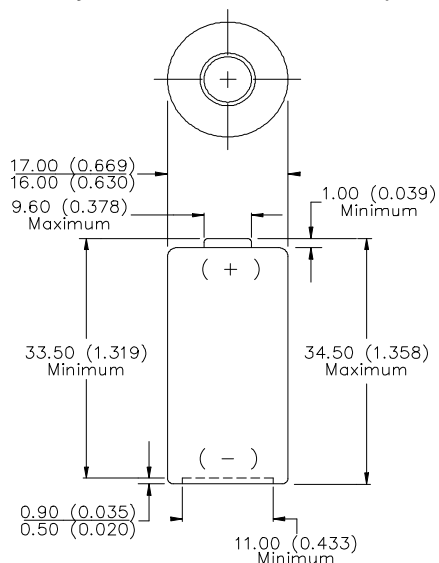

Industry Standard Dimensions in mm (inches)



THIS BATTERY HAS UNDERWRITERS LABORATORIES COMPONENT RECOGNITION

This battery Contains a Positive Temperature Coefficient (PTC) Device to Limit Current Flow

Simulated Application Test  
 Estimated Average Service at 21°C (70°F)

Schedule:	Typical Drains (mA)	Load (ohms)	Cutoff Voltage		
			2.0 V Hours	1.55 V Cycles	1.3 V Cycles
24 hours/day	-	100	50.7	-	-
24 hours/day	1000	-	0.85	-	-
3 sec ON / 7 sec OFF	1200	-	-	-	1325
3 sec ON / 27 sec OFF	900	-	-	1850	-

**Chemical System:** Lithium  
 Lithium/Manganese Dioxide (Li/MnO<sub>2</sub>)

**Designation:** ANSI / NEDA-5018LC, IEC-CR17345  
**Battery Voltage:** 3.0 Volts  
**Average Weight:** 15.5 grams (0.55 oz.)  
**Volume:** 7.1 cubic centimeters (0.4 cubic inch)  
**Average Capacity:** 1300 mAh to 2.0 volts  
 (Rated Capacity at 100 ohms at 21°C)

**Maximum Reverse Charge Current:** 2 microampere  
**Max Discharge:** 1500 mA continuous - 3500 mA pulse  
**Cells:** One 2/3A

Typical Discharge Characteristics  
 Schedule: 3 sec ON / 27 sec OFF  
 Typical Drain: 900 milliamperes

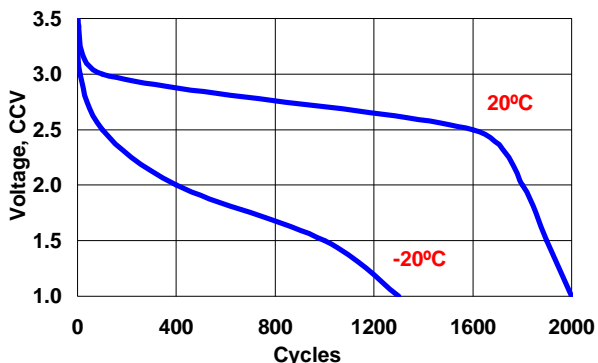

Typical Discharge Characteristics  
 Schedule: 3 sec ON / 7 sec OFF  
 Typical Drain: 1200 milliamperes

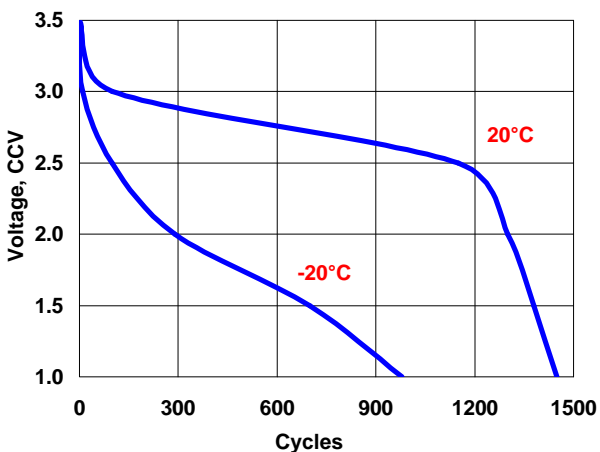

### Important Notice

This data sheet contains information specific to batteries manufactured at the time of its publication.

**Contents herein do not constitute a warranty.**

Copyright © Eveready Battery Co. Inc. - All Rights Reserved